



## CONTACT US

Airtight Fluid Transfer Tech CO., Ltd.

P.C.: 215300

TEL: +86-512-36867553

FAX: +86-512-36821115

E-MAIL: [exportsales.sa@airtightpipe.com](mailto:exportsales.sa@airtightpipe.com)

ADD: NO.99, Hongxing Road, Qiandeng Town, Kunshan City, Jiangsu Province, China

# CATALOGUE

SAFE | FAST | DURABLE

ENERGY SAVING | ENVIRONMENT PROTECTION

[WWW.AIRTIGHTPIPE.COM](http://WWW.AIRTIGHTPIPE.COM)

## 10 Years Quality Assurance

Consistent with the high-quality performance of Airtight series products, we give customers a 10-year quality guarantee, and we promise to compensate for the loss of Airtight accessories and aluminum tubes caused by any material defects.



## About Airtight

Established in 2015, Airtight Fluid Transfer Tech Co., Ltd. is an enterprise specializing in the R&D, production, sales and installation services of aluminum alloy quick-installation pipelines. We are located in Suzhou, Jiangsu, China, with convenient transportation access.

Covering an area of 5000 square meters, we have over 80 employees, an annual sales figure that exceeds 100 million RMB. Our well-equipped facilities and excellent quality control throughout all stages of production enables us to guarantee total customer satisfaction. Besides, we have received CE certification, ISO9001, ISO14001 etc.

If you are interested in any of our products or would like to discuss an order, please feel free to contact us. We are looking forward to forming successful business relationships with new clients around the world in the near future.

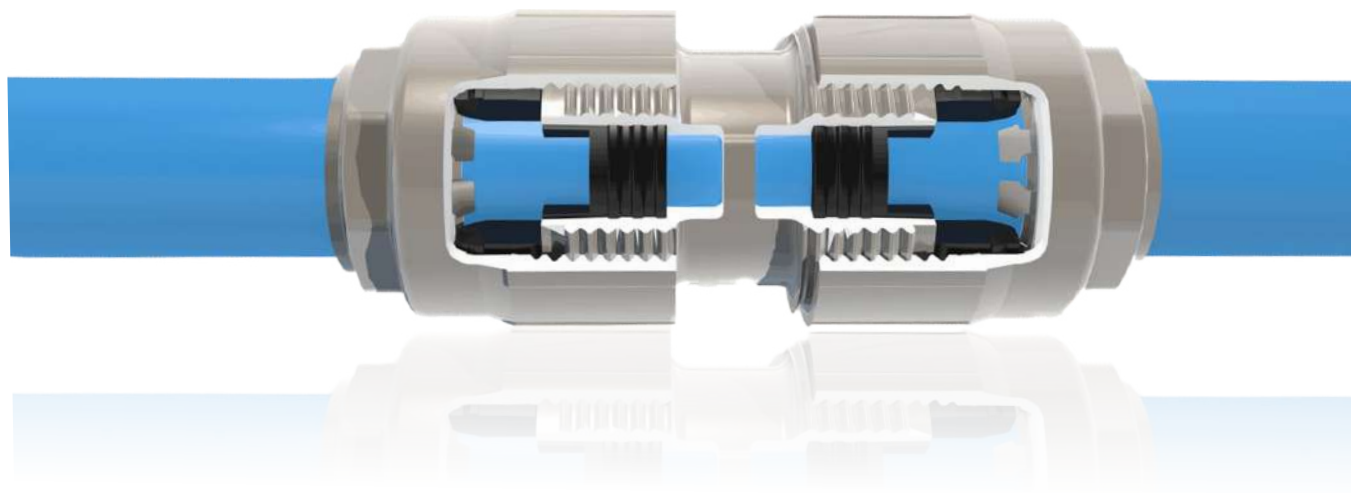

# CONTENT



03	-----	Ordering Code
05	-----	Certification and Guarantee
06	-----	Product Information
07	-----	Aluminum Pipe
09	-----	Pipe Fittings
17	-----	Auxiliary Material
21	-----	Auxiliary Instrument
22	-----	Terminal Connector
23	-----	Tools
25	-----	Installation Guidelines

Eg

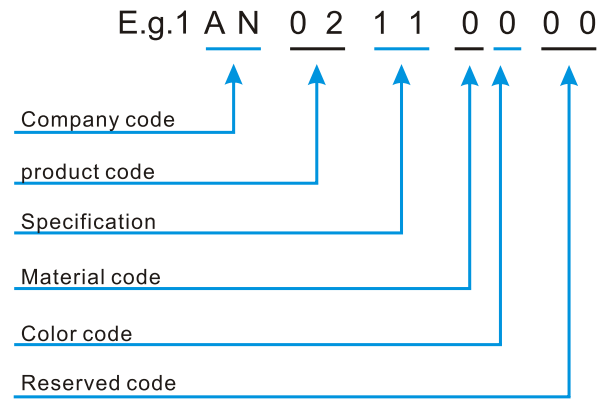

E.g. 1 is suitable for products with pipe size

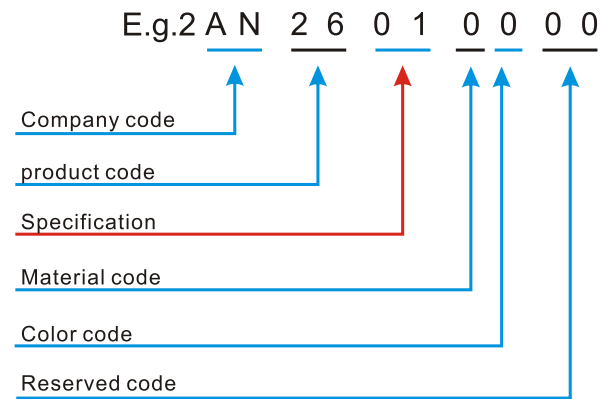

E.g. 2 is suitable for products with fittings and others materials

\* The left example "AN02110000" represents the product for DN20 Fast-install equal coupling. Here is The comparison table.

Model code		Port size	Port size	Body material	Color code
00: 5.8m Aluminun tube	18: Fixing clip	0 : <DN20mm	0 : <DN20mm	0: Aluminum	0: Champagne silver
01: 2.9m Aluminun tube	19: Flexible hose	1 : DN20mm	1 : DN20mm	1: Copper	1: Blue
02: Pipe-to-pipe connector	20: Single insertion female valve	2 : DN25mm	2 : DN25mm	2: Carbon steel	2: Yellow
03: 90° Elbow	21: Male adaptor	3 : DN32mm	3 : DN32mm	3: Stainless steel	3: Gray
04: Equal tee	22: Adapter	4 : DN40mm	4 : DN40mm	4: Plastic	4: Natural color
05: Reducing tee	23: S tube	5 : DN50mm	5 : DN50mm		5: Galvanized
06: Endcap	24: Accessories	6 : DN63mm	6 : DN63mm		6: Dacromet
07: Male stud fitting	25: Tools	7 : DN80mm	7 : DN80mm		7: CP
08: Female stud fitting	26: Teminal	8 : DN100mm	8 : DN100mm		8: Nickel-plated
09: Quick assembly brackets	27: Auxilary instrument	9 : DN125mm	9 : DN125mm		
10: Quick assembly brackets with female thread	28: 90° Quick assembly brackets	A : DN148mm	A : DN148mm		
11: Double female valve	29: 90° Quick assembly brackets with female thread	B : DN200mm	B : DN200mm		
12: Male-female ball valve	30 :				
13: Double female valve, BSP parallel	31 :				
14: Handle butterfly valve	32 :				
15: Butterfly Valve	33 :				
16: Equal flange	34 :	X: Diameter of general	X: Diameter of general		
17: Reducing flange					



## ● Certification and Guarantee

### Standards and Certification

- GB/T4437.1-2015
- GB / T24001 - 2016 / ISO14001 : 2015
- GB / T19001 - 2016 / ISO9001 : 2015
- CE certification
- Type test certificate of special equipment
- GC2 Installation Qualification
- Aluminium and aluminium alloy extruded tubes
- Environmental management system
- Quality management system
- European standard 97 / 23 / EC - 3.3
- Manufacture license of special equipment
- Three level safety production standardization
- All threaded joints are BSP , special specifications can be customized.

### Technical Specifications

- Suitable fluids : compressed air , vacuum , inert gas ( Ar , N<sub>2</sub> , CO<sub>2</sub>) etc.
- Working pressure ≤ 16bar
- Vacuum : 98 , 7% ( 13 mbar absolute pressure )
- Working range temperature : - 30 to + 80°C
- Working environment : mechanical shocks , aggressive environments , corrosion , thermal variations , U . V . , compressor oil carry over

#### DN20-DN25 Fittings Series



- Body : Die-casting aluminum,
- Buxing : Fiber-containing Pa66 material
- Locking Ring : Stainless Stell
- Seal : Silica Gel , EPDM
- \* Product Code
- \* Company Logo
- \* Date of Manufacture

#### Over DN40 Fittings Series



- Body : Die-casting aluminum,
- Seal : Silica Gel , EPDM
- \* Product Code
- \* Company Logo
- \* Date of Manufacture

#### Rigid Aluminium Pipe



- Aluminium alloy A96063 T5
- Maximum Design Pressure
- Printing
- \* Product Code
- \* Company Logo
- \* Date of Manufacture

### Test

- 500 hours of Salt Spray Test
- High Pressure Test
- Blasting Pressure Test
- Leakage Test Under Different Frequency Vibration Periods
- Testing Under Pressure Fluctuation Test

## ● Product Information



Pipeline Series	Φ20mm 3/4"	Φ25mm 1"	Φ40mm 1 1/2"	Φ50mm 2"	Φ63mm 2 1/2"	Φ80mm 3"	Φ100mm 4"	Φ125mm 5"	Φ150mm 6"	Φ200mm 8"
Diameter Specification	✓	✓	✓	✓	✓	✓	✓	✓	✓	✓
S-type elbow	✓	✓								
U-type elbow	✓	✓								
90°elbow										

Pipeline Series	Φ20mm 3/4"	Φ25mm 1"	Φ40mm 1 1/2"	Φ50mm 2"	Φ63mm 2 1/2"	Φ80mm 3"	Φ100mm 4"	Φ125mm 5"	Φ150mm 6"	Φ200mm 8"
Fast-install pipe union	✓	✓	✓	✓	✓	✓	✓	✓	✓	✓
Fast-install reducer		✓	✓	✓	✓	✓	✓	✓	✓	✓
Fast-install 90°elbow	✓	✓	✓	✓	✓	✓	✓	✓	✓	✓
Fast-install equal tee	✓	✓	✓	✓	✓	✓	✓	✓	✓	✓
Fast-install reducer tee		✓	✓	✓	✓	✓	✓	✓	✓	✓
Fast-install endcap	✓	✓	✓	✓	✓	✓	✓	✓	✓	✓
Fast-install equal size flange				✓	✓	✓	✓	✓	✓	✓
Fast-install reducer flange				✓	✓	✓	✓	✓	✓	✓



Pipeline Series	Φ20mm 3/4"	Φ25mm 1"	Φ40mm 1 1/2"	Φ50mm 2"	Φ63mm 2 1/2"	Φ80mm 3"	Φ100mm 4"	Φ125mm 5"	Φ150mm 6"	Φ200mm 8"
Fast-install handle butterfly valve					✓	✓	✓	✓	✓	✓
Fast-install turbo butterfly valve					✓	✓	✓	✓	✓	✓
Fast-install external thread pipe union	✓	✓	✓	✓	✓	✓				
Fast-install internal thread pipe union	✓	✓	✓	✓	✓	✓				
Fast-branch tee		✓	✓	✓	✓	✓	✓	✓	✓	✓
Fast-branch internal thread tee		✓	✓	✓	✓	✓	✓	✓	✓	✓
Fast-install cooper valve	✓	✓	✓	✓						
Fast-install single thread valve	✓	✓								
Fast-install thread valve	✓	✓								

\*According to the actual needs of customers, we provide various diameter pipes for you to choose.

\*According to various pipe fittings conversion form,meet different working conditions.

Note: pls feel free to contact us in case of any further questions



# Aluminium Alloy Pipe Series



Blue Aluminium Alloy Pipe					
Code	Specifications	Outer diameter mm	Inner diameter mm	Length m	Description
AN00110100	20	20.2	17.2	5.8	Blue Aluminium Alloy Pipe, 5.8m, DN20
AN00220100	25	25.2	22.2	5.8	Blue Aluminium Alloy Pipe, 5.8m, DN25
AN00440100	40	40.2	36.6	5.8	Blue Aluminium Alloy Pipe, 5.8m, DN40
AN00550100	50	50.2	46.2	5.8	Blue Aluminium Alloy Pipe, 5.8m, DN50
AN00660100	63	63.2	58.4	5.8	Blue Aluminium Alloy Pipe, 5.8m, DN63
AN00770100	80	80.2	75	5.8	Blue Aluminium Alloy Pipe, 5.8m, DN80
AN00880100	100	100.2	94.6	5.8	Blue Aluminium Alloy Pipe, 5.8m, DN100
AN00990100	125	125.2	119.6	5.8	Blue Aluminium Alloy Pipe, 5.8m, DN125
AN00CC0100	148	148.2	142.2	5.8	Blue Aluminium Alloy Pipe, 5.8m, DN148
AN00BB0100	200	205.2	198.4	5.8	Blue Aluminium Alloy Pipe, 5.8m, DN200

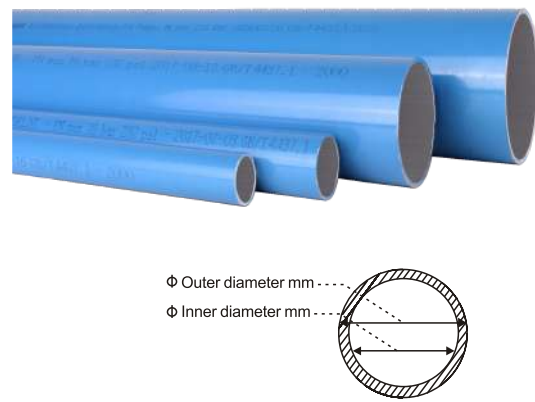

# Aluminium Alloy Pipe Series

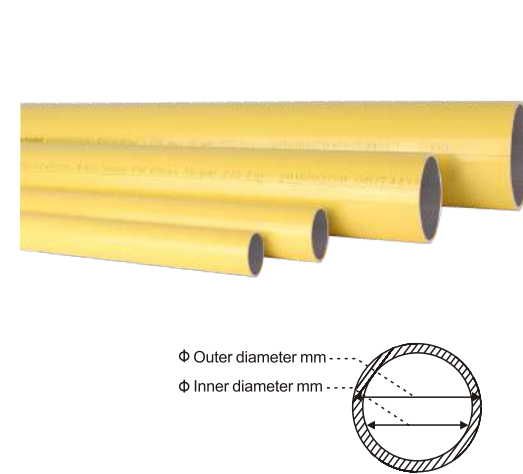

Yellow Aluminium Alloy Pipe					
Code	Specifications	Outer diameter mm	Inner diameter mm	Length m	Description
A N 00110200	20	20.2	17.2	5.8	Yellow Aluminium Alloy Pipe, 5.8m, DN20
AN 00220200	25	25.2	22.2	5.8	Yellow Aluminium Alloy Pipe, 5.8m, DN25
A N 00440200	40	40.2	36.6	5.8	Yellow Aluminium Alloy Pipe, 5.8m, DN40
A N 00550200	50	50.2	46.2	5.8	Yellow Aluminium Alloy Pipe, 5.8m, DN50
A N 00660200	63	63.2	58.4	5.8	Yellow Aluminium Alloy Pipe, 5.8m, DN63
A N 00770200	80	80.2	75	5.8	Yellow Aluminium Alloy Pipe, 5.8m, DN80
A N 00880200	100	100.2	94.6	5.8	Yellow Aluminium Alloy Pipe, 5.8m, DN100
A N 00990200	125	125.2	119.6	5.8	Yellow Aluminium Alloy Pipe, 5.8m, DN125
A N 00CC0200	148	148.2	142.2	5.8	Yellow Aluminium Alloy Pipe, 5.8m, DN148
A N 00BB0200	200	205.2	198.4	5.8	Yellow Aluminium Alloy Pipe, 5.8m, DN200

Gray Aluminium Alloy Pipe					
Code	Specifications	Outer diameter mm	Inner diameter mm	Length m	Description
A N 00110300	20	20.2	17.2	5.8	Gray Aluminium Alloy Pipe, 5.8m, DN20
AN 00220300	25	25.2	22.2	5.8	Gray Aluminium Alloy Pipe, 5.8m, DN25
A N 00440300	40	40.2	36.6	5.8	Gray Aluminium Alloy Pipe, 5.8m, DN40
A N 00550300	50	50.2	46.2	5.8	Gray Aluminium Alloy Pipe, 5.8m, DN50
A N 00660300	63	63.2	58.4	5.8	Gray Aluminium Alloy Pipe, 5.8m, DN63
A N 00770300	80	80.2	75	5.8	Gray Aluminium Alloy Pipe, 5.8m, DN80
A N 00880300	100	100.2	94.6	5.8	Gray Aluminium Alloy Pipe, 5.8m, DN100
A N 00990300	125	125.2	119.6	5.8	Gray Aluminium Alloy Pipe, 5.8m, DN125
A N 00CC0300	148	148.2	142.2	5.8	Gray Aluminium Alloy Pipe, 5.8m, DN148
A N 00BB0300	200	205.2	198.4	5.8	Gray Aluminium Alloy Pipe, 5.8m, DN200

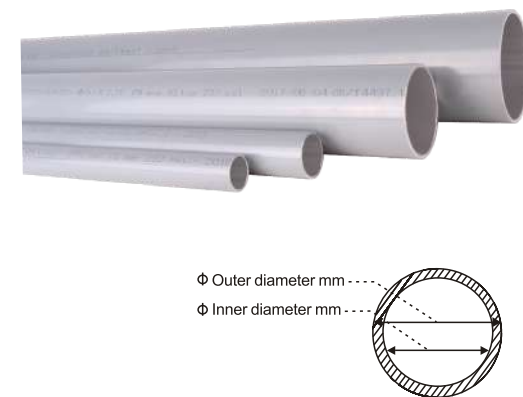

# Pipe Fittings Series

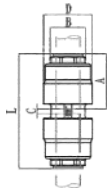

Equal Coupling						
Code	Specifications	L	A	B	D	Description
AN02110000	20	95	45.5	29	40	Equal Coupling DN20
AN02220000	25	105	50	34	45.6	Equal Coupling DN25
AN02440000	40	140	70	55	72.5	Equal Coupling DN40
AN02550000	50	140	70	65	82.5	Equal Coupling DN50

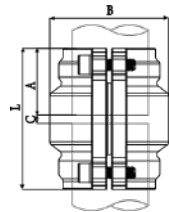

Equal Coupling						
Code	Specifications	L	A	B	Description	
AN02660000	63	125	60	97	Equal Coupling DN63	
AN02770000	80	125	60	113	Equal Coupling DN80	
AN02880000	100	150	72	135	Equal Coupling DN100	
AN02990000	125	150	72	160	Equal Coupling DN125	
AN02CC0000	148	140	67	185	Equal Coupling DN148	
AN02BB0000	200	160	77	248	Equal Coupling DN200	

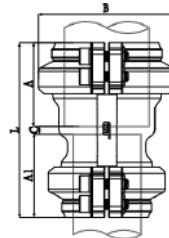

Reducer							
Code	Specifications	L	A	B	A1	C	Description
AN02210000	25	100	50	45.6	45.5	4	Reducer DN25-DN20
AN02420000	40	104	50	62	50	4	Reducer DN40-DN25
AN02540000	50	104	50	75	50	4	Reducer DN50-DN40
AN02650000	63	110	56	96	50	4	Reducer DN63-DN50
AN02760000	80	120	60	113	65	4	Reducer DN80-DN63
AN02870000	100	139	72	135	60	5	Reducer DN100-DN80
AN02980000	125	149	72	160	72	5	Reducer DN125-DN100

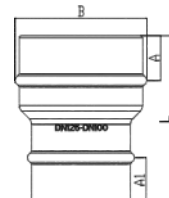

Reducer Without Coupling							
Code	Specifications	L	A	B	A1	Description	
AN02540001	50-40	96	30	54	30	Reducer Without Coupling DN50-DN40	
AN02650001	63-50	118	45	71	30	Reducer Without Coupling DN63-DN50	
AN02760001	80-63	140	45	88	45	Reducer Without Coupling DN80-DN63	
AN02870001	100-80	152	45	108	45	Reducer Without Coupling DN100-DN80	
AN02980001	125-100	168	45	133	45	Reducer Without Coupling DN125-DN100	
AN02C80000	148-100	170	45	156	45	Reducer Without Coupling DN148-DN100	
AN02C90000	148-125	170	45	156	45	Reducer Without Coupling DN148-DN125	
AN02BC0000	200-148	170	45	214	45	Reducer Without Coupling DN200-DN148	

Remarks : The above shall be additionally equipped with the same diameter

# Pipe Fittings Series

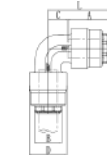

90° Elbow							
Code	Specifications	L	A	B	C	D	Description
AN03110000	20	66	45.5	29	20.5	40	90° Elbow DN20
AN03220000	25	74	50	34	24	45.6	90° Elbow DN25

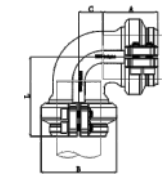

90° Elbow							
Code	Specifications	L	A	B	C	Description	
AN03440000	40	72	50	62	27	90° Elbow DN40	
AN03550000	50	77	50	75	27	90° Elbow DN50	
AN03660000	63	88	56	96	42	90° Elbow DN63	
AN03770000	80	102	60	113	42	90° Elbow DN80	
AN03880000	100	125	72	135	53	90° Elbow DN100	
AN03990000	125	138	72	160	66	90° Elbow DN125	

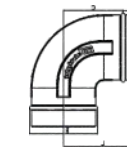

90° Elbow Without Coupling							
Code	Specifications	L	A	B	C	Description	
AN03CC0000	148	175	45	156	130	90° Elbow Without Coupling DN148	
AN03BB0000	200	257.5	55	214	202.5	90° Elbow Without Coupling DN200	

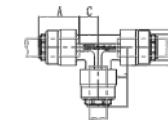

Equal Tee							
Code	Specifications	L	A	B	C	D	Description
AN04110000	20	66	45.5	29	20.5	40	Equal Tee DN20
AN04220000	25	74	50	34	24	45.6	Equal Tee DN25

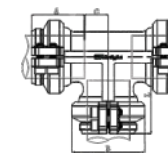

Equal Tee							
Code	Specifications	L	A	B	C	Description	
AN04440000	40	72	50	62	27	Equal Tee DN40	
AN04550000	50	77	50	75	27	Equal Tee DN50	
AN04660000	63	88	56	96	42	Equal Tee DN63	
AN04770000	80	102	60	113	42	Equal Tee DN80	
AN04880000	100	125	72	135	53	Equal Tee DN100	
AN04990000	125	138	72	160	66	Equal Tee DN125	

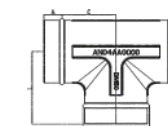

Equal Tee Without Coupling							
Code	Specifications	L	A	B	C	Description	
AN04CC0000	148	174	45	156	129	Equal Tee Without Coupling DN148	
AN04BB0000	200	202	45	214	157.5	Equal Tee Without Coupling DN200	

# Pipe Fittings Series

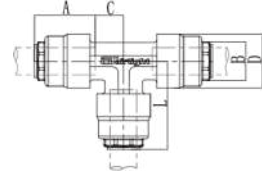

## Reducing Tee

Code	Specifications	L	A	B	D	Description
AN0521000	25-20	70	50	34	23	Reducing Tee DN25-DN20

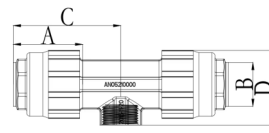

## Female Reducing Tee

Code	Specifications	L	A	B	D	Description
AN05100000	DN20-1/2"	26	45.5	29	40	Female Reducing Tee DN20-1/2"
AN05200000	DN25-1/2"	28	50	34	45	Female Reducing Tee DN25-1/2"

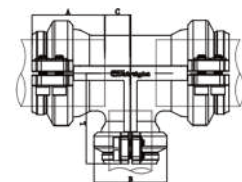

## Reducing Tee

Code	Specifications	L	A	B	C	Description
AN05640000	63-40	78	56	76	32	Reducing Tee DN63-DN40
AN05750000	80-50	82	60	113	42	Reducing Tee DN80-DN50
AN05860000	100-63	96	72	135	53	Reducing Tee DN100-DN63
AN05970000	125-80	108	72	160	66	Reducing Tee DN125-DN80

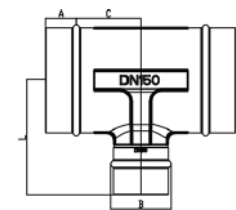

## Reducing Tee Without Coupling

Code	Specifications	L	A	B	C	Description
AN05C60000	148-63	164	45	70	87	Reducing Tee Without Coupling DN148-DN63
AN05C70000	148-80	164	45	73	95	Reducing Tee Without Coupling DN148-DN80
AN05C80000	148-100	174	45	107	105	Reducing Tee Without Coupling DN148-DN100
AN05C90000	148-125	174	45	132	117	Reducing Tee Without Coupling DN148-DN125
AN05B60000	200-63	200	45	70	100.5	Reducing Tee Without Coupling DN200-DN63
AN05B70000	200-80	200	45	73	100.5	Reducing Tee Without Coupling DN200-DN80
AN05B80000	200-100	200	45	107	100.5	Reducing Tee Without Coupling DN200-DN100
AN05B90000	200-125	212	45	134	135	Reducing Tee Without Coupling DN200-DN125
AN05BC0000	200-148	212	45	158	135	Reducing Tee Without Coupling DN200-DN148

# Pipe Fittings Series

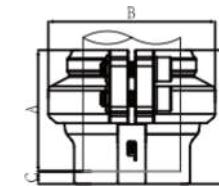

## Endcap

Code	Specifications	L	A	B	D	Description
AN06110000	20	50	45.5	40	5	Endcap DN20
AN06220000	25	55	50	45.6	5	Endcap DN25
AN06440000	40	55	50	62	5	Endcap DN40
AN06550000	50	55	50	75	5	Endcap DN50
AN06660000	63	62	56	96	6	Endcap DN63
AN06770000	80	68	60	113	8	Endcap DN80
AN06880000	100	75	72	135	8	Endcap DN100
AN06990000	125	75	72	160	8	Endcap DN125

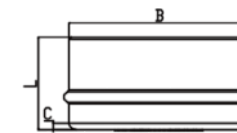

## Endcap Without Coupling

Code	Specifications	L	B	C	Description
AN06CC0000	148	75	156	10	Endcap Without Coupling DN148
AN06BB0000	200	85	205	10	Endcap Without Coupling DN200

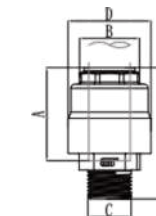

## Male Fitting

Code	Specifications	L	A	B	C	D	Description
AN07100000	20	63	45.5	29	1/2"	40	Male Fitting DN20-R1/2"
AN07110000	20	63	45.5	29	3/4"	40	Male Fitting DN20-R3/4"
AN07210000	25	73	50	34	1/2"	45.6	Male Fitting DN25-R3/4"
AN07220000	25	73	50	34	1"	45.6	Male Fitting DN25-R1"

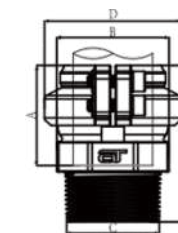

## Male Fitting

Code	Specifications	L	A	B	C	D	Description
AN07420000	40	78	50	56.3	1"	67	Male Fitting DN40-R1 "
AN07440000	40	78	50	56.3	1 1/2"	67	Male Fitting DN40-R1 1/2"
AN07540000	50	79	50	66.5	1 1/2"	77	Male Fitting DN50-R1 1/2"
AN07550000	50	79	50	66.5	2"	77	Male Fitting DN50-R2 "
AN07650000	63	96	56	83	2"	97	Male Fitting DN63-R2 "
AN07660000	63	96	56	83	2 1/2"	97	Male Fitting DN63-R2 1/2"
AN07760000	80	110	60	97	2 1/2"	114	Male Fitting DN80-R2 1/2"
AN07770000	80	110	60	97	3"	114	Male Fitting DN80-R3 "



# Pipe Fittings Series



90° Drilling Tee					
Code	Specifications	L	A	B	Description
AN28210000	25	95	45.5	60	90° Drilling Tee DN25-DN20

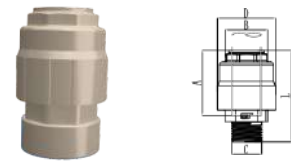

Female Fitting							
Code	Specifications	L	A	B	C	D	Description
AN08110000	20	63	45.5	29	3/4"	40	Female Fitting DN20-G3/4"
AN08220000	25	73	50	34	1"	45.6	Female Fitting DN25-G1"



Female Fitting							
Code	Specifications	L	A	B	C	D	Description
AN08440000	40	78	50	56.3	1 1/2"	67	Female Fitting DN40-G1 1/2"
AN08550000	50	79	50	66.5	2"	77	Female Fitting DN50-G2"
AN08660000	63	96	56	83	2 1/2"	97	Female Fitting DN63-G2 1/2"
AN08770000	80	110	60	97	3"	114	Female Fitting DN80-G3"

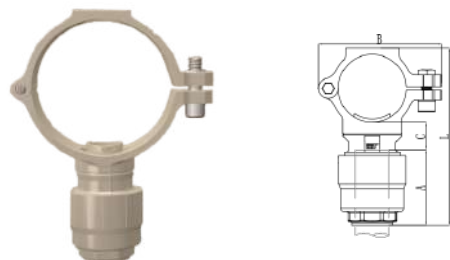

Drilling Tee						
Code	Specifications	L	A	B	C	Description
AN09410000	40	106	45.5	74	16	Drilling Tee DN40-DN20
AN09510000	50	116	45.5	84	16	Drilling Tee DN50-DN20
AN09610000	63	133	45.5	101	19	Drilling Tee DN63-DN20
AN09710000	80	150	45.5	117	19	Drilling Tee DN80-DN20
AN09810000	100	171	45.5	139	19	Drilling Tee DN100-DN20
AN09910000	125	198	45.5	164	22	Drilling Tee DN125-DN20
AN09C10000	148	228	45.5	198	28	Drilling Tee DN148-DN20
AN09B10000	200	288	45.5	257	28	Drilling Tee DN200-DN20
AN09420000	40	109	50	74	14	Drilling Tee DN40-DN25
AN09520000	50	121	50	84	16	Drilling Tee DN50-DN25
AN09620000	63	138	50	101	20	Drilling Tee DN63-DN25
AN09720000	80	155	50	117	20	Drilling Tee DN80-DN25
AN09820000	100	178	50	139	20	Drilling Tee DN100-DN25
AN09920000	125	203	50	164	22	Drilling Tee DN125-DN25
AN09C20000	148	233.5	50	198	28	Drilling Tee DN148-DN25
AN09B20000	200	298	50	257	28	Drilling Tee DN200-DN25

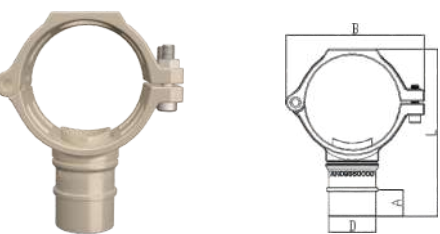

Drilling Tee Without Coupling						
Code	Specifications	L	A	B	C	Description
AN09740000	DN80	149.5	30	127	40	Drilling Tee Without Coupling DN80-DN40
AN09750000	DN80	155.5	30	127	50	Drilling Tee Without Coupling DN80-DN50
AN09840000	DN100	174	30	136	40	Drilling Tee Without Coupling DN100-DN40
AN09850000	DN100	178	30	136	50	Drilling Tee Without Coupling DN100-DN50
AN09940000	DN125	200	30	164	40	Drilling Tee Without Coupling DN125-DN40
AN09950000	DN125	204	30	164	50	Drilling Tee Without Coupling DN125-DN50
AN09C40000	DN148	220	30	196	40	Drilling Tee Without Coupling DN148-DN40
AN09C50000	DN148	220	30	196	50	Drilling Tee Without Coupling DN148-DN50
AN09B40000	DN200	282	30	250	40	Drilling Tee Without Coupling DN200-DN40
AN09B50000	DN200	286	30	250	50	Drilling Tee Without Coupling DN200-DN50

# Pipe Fittings Series



Male-female Copper Ball Valve							
Code	Specifications	L	D1	D2	B	H	Description
AN12001000	15	59	1/2"	1/2"	96	40	Male-female copper ball valve G1/2"
AN12221000	25	71	1"	1"	119	55	Male-female copper ball valve G1"



90° Drilling Female Tee					
Code	Specifications	L	A	B	Description
AN29200000	25	70	1/2"	65	90° Drilling Female Tee DN25-G1/2"

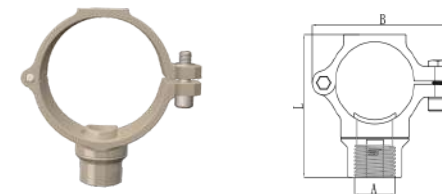

Drilling Female Tee					
Code	Specifications	L	A	B	Description
AN10400000	40	71	1/2"	74	Drilling Female Tee DN40-G1/2"
AN10500000	50	82	1/2"	84	Drilling Female Tee DN50-G1/2"
AN10600000	63	99	1/2"	101	Drilling Female Tee DN63-G1/2"
AN10620000	63	99	1"	101	Drilling Female Tee DN63-G1"
AN10720000	80	116	1"	117	Drilling Female Tee DN80-G1"
AN10700000	80	116	1 1/2"	117	Drilling Female Tee DN80-G1 1/2"
AN10820000	100	137	1"	139	Drilling Female Tee DN100-G1"
AN10920000	125	164	1"	164	Drilling Female Tee DN125-G1"
AN10C20000	148	179	1"	198	Drilling Female Tee DN148-G1"
AN10B00000	200	239	1"	257	Drilling Female Tee DN200-G1"



Female Copper Ball Valve							
Code	Specifications	L	D1	D2	B	H	Description
AN13111000	15	60	1/2"	1/2"	96	49	Female copper ball valve G1/2"
AN13221000	25	68	1"	1"	96	52	Female copper ball valve G1"
AN13441000	40	102	1 1/2"	1 1/2"	133.5	68.5	Female copper ball valve G1 1/2"
AN13551000	50	119	2"	2"	145	81.5	Female copper ball valve G2"

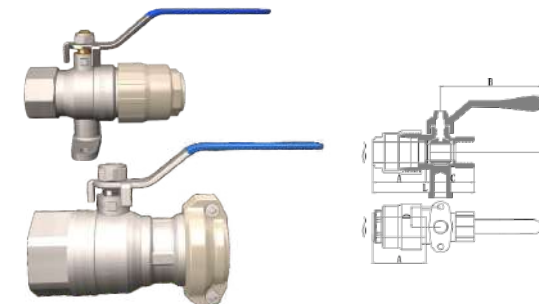

Quick Assembly Female Copper Ball Valve							
Code	Specifications	L	A	B	C	H	Description
AN20010000	20	86	45.5	85	41	50	Quick assembly female copper ball valve DN20-G1/2"
AN20210000	25	105	50	99	55	60	Quick assembly female copper ball valve DN25-G1/2"
AN20220000	25	105	50	99	55	60	Quick assembly female copper ball valve DN25-G1"
AN20440000	40	125	50	140	56	76	Quick assembly female copper ball valve DN40-G1 1/2"
AN20550000	50	145	50	155	69	87	Quick assembly female copper ball valve DN50-G2"

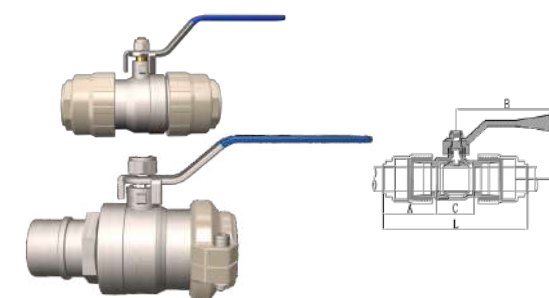

Quick Assembly Butt-plug Valve							
Code	Specifications	L	A	B	C	H	Description
AN11110000	20	122	45.5	85	32	53	Quick assembly copper ball valve DN20
AN11220000	25	135	50	99	35	60	Quick assembly copper ball valve DN25
AN11440000	40	156	50	140	56	76	Quick assembly copper ball valve DN40
AN11550000	50	170	50	155	69	87	Quick assembly copper ball valve DN50
AN11660000	63	217	80	165	80	95	Quick assembly copper ball valve DN63

## Pipe Fittings Series

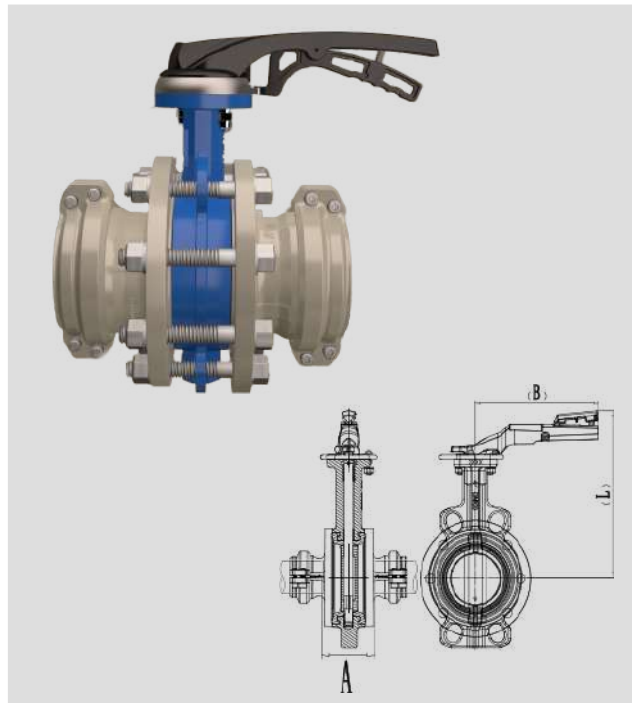

### Handle Butterfly Valve

Code	Specifications	L	A	B	Description
AN14663100	65	230	82	200	Handle Butterfly Valve(304 Stainless Steel) DN65
AN14773100	80	237	84	200	Handle Butterfly Valve(304 Stainless Steel) DN80
AN14883100	100	256	90	200	Handle Butterfly Valve(304 Stainless Steel) DN100



### Turbine Butterfly Valve

Code	Specifications	L	A	B	Description
AN15993100	125	234	94	162	Handle Butterfly Valve(304 Stainless Steel) DN125
AN15CC3100	148	247	94	162	Handle Butterfly Valve(304 Stainless Steel) DN148
AN15BB3100	200	281	98	202	Handle Butterfly Valve(304 Stainless Steel) DN200

## Pipe Fittings Series

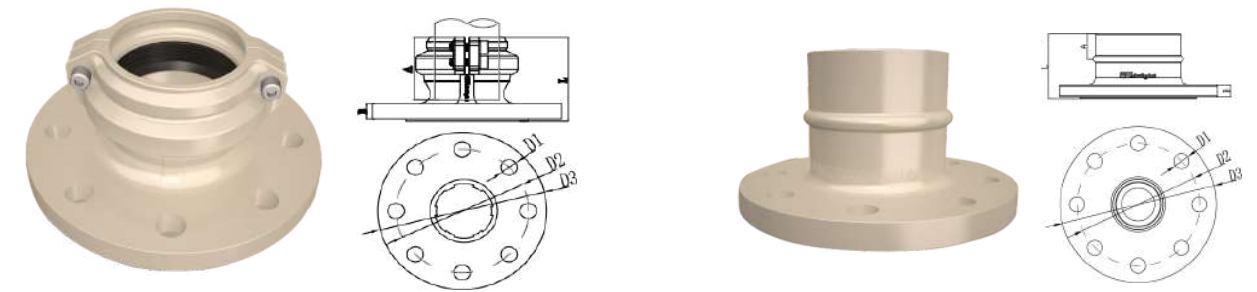

### Equal Flange

Code	Import	Outlet	A	B	L	D1	D2	D3	Description
AN16550000	50	50	30	16.5	70	18	125	165	Equal Flange DN50
AN16660000	63	63	56	16.5	91	18	145	185	Equal Flange DN65
AN16770000	80	80	60	16.5	91	18	160	200	Equal Flange DN80
AN16880000	100	100	72	16.5	107	18	180	220	Equal Flange DN100
AN16990000	125	125	72	16.5	110	18	210	250	Equal Flange DN125

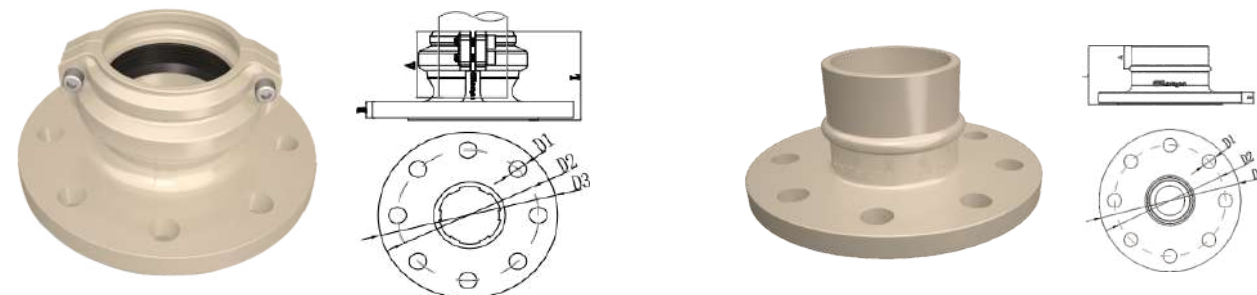

### Equal Flange Without Coupling

Code	Import	Outlet	A	B	L	D1	D2	D3	Description
AN16CC0000	150	148	45	22	118	22	240	285	Equal Flange Without Coupling DN148
AN16BB0000	200	200	45	22	125	22	295	340	Equal Flange Without Coupling DN200

\* Standard configuration with flange seal, flange bolts

### Reducing Flange

Code	Import	Outlet	A	B	L	D1	D2	D3	Description
AN17560000	50	63	40	16.5	94	18	125	165	Reducing Flange 50-DN63
AN17650000	65	50	30	16.5	70	18	145	185	Reducing Flange 65-DN50
AN17670000	65	80	45	16.5	94	18	145	185	Reducing Flange 65-DN80
AN17760000	80	63	45	16.5	99	18	160	200	Reducing Flange 80-DN63
AN17780000	80	100	45	16.5	107	18	160	200	Reducing Flange 80-DN100
AN17860000	100	65	45	16.5	110	18	180	220	Reducing Flange 100-DN63
AN17870000	100	80	45	16.5	110	18	180	220	Reducing Flange 100-DN80

### Reducing Flange Without Coupling

Code	Import	Outlet	A	B	L	D1	D2	D3	Description
AN17890000	100	125	72	16.5	110	18	180	220	Reducing Flange Without Coupling DN100-DN125
AN17970000	125	80	45	16.5	110	18	210	250	Reducing Flange Without Coupling DN125-DN80
AN17980000	125	100	45	16.5	110	18	210	250	Reducing Flange Without Coupling DN125-DN100
AN179C0000	125	148	45	16.5	110	18	210	250	Reducing Flange Without Coupling DN125-DN148
AN17A80000	150	100	45	22	118	22	240	285	Reducing Flange Without Coupling DN150-DN100
AN17A90000	150	125	45	22	118	22	240	285	Reducing Flange Without Coupling DN150-DN125

\* Standard configuration with flange seal, flange bolts  
\* Others need to be matched with equal union



# Auxiliary Material Series

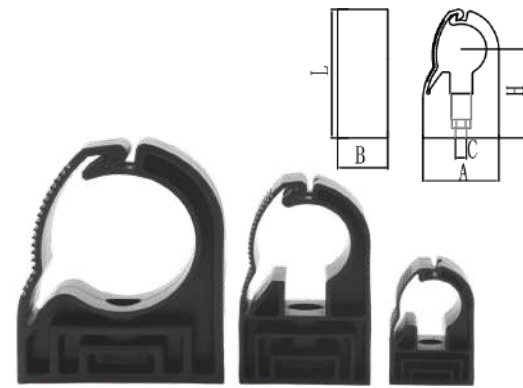

Clamp							
Code	Specifications	L	A	B	C	H	Description
AN18110000	20	56	32	30	M8	40	Clamp, DN20(Polymer)
AN18220000	25	60	38	30	M8	40	Clamp, DN25(Polymer)
AN18440000	40	100	60	40	M8	70	Clamp, DN40(Polymer)
AN18550000	50	110	75	40	M8	70	Clamp, DN50(Polymer)
AN18660000	63	118	94	40	M8	70	Clamp, DN63(Polymer)
AN18770000	80	160	120	50	M8	100	Clamp, DN80(Polymer)
AN18884400	100	190	140	50	M8	120	Clamp, DN100(Polymer)
AN18994400	125	210	160	50	M8	130	Clamp, DN125(Polymer)



U Type Clamp						
Code	Specifications	L	A	B	C	Description
AN18AA2500	150	210	152	80	M10	U Type Clamp, DN150(Carbon Steel)
AN18BB2500	200	250	202	100	M10	U Type Clamp, DN200(Carbon Steel)

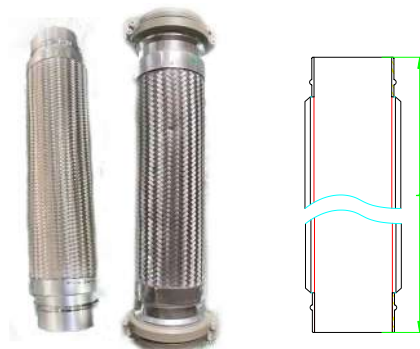

Flexible Hose						
Code	Specifications	L	A	B	Description	
AN19113400	20	500	45.5	180°	Flexible Hose(304 Stainless Steel),0.5m,180°DN20	
AN19223400	25	500	45.5	180°	Flexible Hose(304 Stainless Steel),0.5m,180°DN25	
AN19443400	40	800	40	30°	Flexible Hose(304 Stainless Steel),0.6m,180°DN40	
AN19553400	50	800	40	30°	Flexible Hose(304 Stainless Steel),0.6m,180°DN50	
AN19663400	63	800	54	30°	Flexible Hose(304 Stainless Steel),0.6m,180°DN63	
AN19773400	80	800	54	30°	Flexible Hose(304 Stainless Steel),0.6m,180°DN80	
AN19883400	100	600	70	180°	Flexible Hose(304 Stainless Steel),0.6m,180°DN100	
AN19993400	125	600	74	180°	Flexible Hose(304 Stainless Steel),0.6m,180°DN125	
AN19CC3400	148	800	45	180°	Flexible Hose(304 Stainless Steel),0.6m,180°DN148	
AN19BB3400	200	800	45	180°	Flexible Hose(304 Stainless Steel),0.6m,180°DN200	

# Auxiliary Material Series

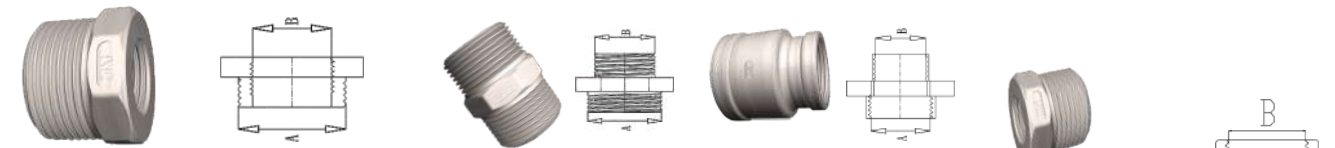

Rotary Union			
Code	Import	Outlet	Description
AN21013401	1/2"	1/2"	Equal male adaptor
AN21013402	3/4"	3/4"	Equal male adaptor
AN21013403	1"	1"	Equal male adaptor
AN21013404	1 1/4"	1 1/4"	Equal male adaptor
AN21013405	1 1/2"	1 1/2"	Equal male adaptor
AN21013406	2"	2"	Equal male adaptor
AN21013407	2 1/2"	2 1/2"	Equal male adaptor
AN21013408	3"	3"	Equal male adaptor

Code	Import	Outlet	Description
AN21033401	1/2"	1/4"	Reducing Female adaptor
AN21033402	1/2"	3/4"	Reducing Female adaptor
AN21033403	1"	1/2"	Reducing Female adaptor
AN21033404	1"	3/4"	Reducing Female adaptor
AN21033405	1"	1 1/2"	Reducing Female adaptor
AN21033406	1"	1 1/4"	Reducing Female adaptor
AN21033407	1 1/2"	1/2"	Reducing Female adaptor
AN21033408	1 1/2"	1 1/4"	Reducing Female adaptor
AN21033409	1 1/2"	2 1/2"	Reducing Female adaptor
AN21033410	2"	1"	Reducing Female adaptor
AN21033411	2"	1 1/4"	Reducing Female adaptor
AN21033412	2"	1 1/2"	Reducing Female adaptor
AN21033413	2"	2 1/2"	Reducing Female adaptor
AN21033414	3"	1 1/2"	Reducing Female adaptor
AN21033415	3"	2 1/2"	Reducing Female adaptor
AN21033416	3"	2"	Reducing Female adaptor
AN21033417	4"	3"	Reducing Female adaptor

Code	Import	Outlet	Description
AN21053401	1"	1"	Straight Internal Thread Union
AN21053402	1 1/2"	1 1/2"	Straight Internal Thread Union
AN21053403	2"	2"	Straight Internal Thread Union
AN21053404	2 1/2"	2 1/2"	Straight Internal Thread Union
AN21053405	3"	3"	Straight Internal Thread Union

Code	Import	Outlet	Description
AN21043401	3/4"	1/2"	Bushing
AN21043402	3/4"	1"	Bushing
AN21043403	1/2"	1/4"	Bushing
AN21043404	1/2"	1"	Bushing
AN21043405	1"	1/2"	Bushing
AN21043406	1"	3/4"	Bushing
AN21043407	1 1/4"	1"	Bushing
AN21043408	1 1/2"	1/2"	Bushing
AN21043409	1 1/2"	1"	Bushing
AN21043410	1 1/2"	1 1/4"	Bushing
AN21043411	2"	1"	Bushing
AN21043412	2"	1 1/2"	Bushing
AN21043413	2 1/2"	2"	Bushing
AN21043414	3"	1 1/2"	Bushing
AN21043415	3"	2"	Bushing
AN21043416	3"	2 1/2"	Bushing



Female Flange							
Code	Size	RC Internal Thread	Screw	D1	D2	D3	H
AN22423400	40	1"	M16	18	110	150	18
AN22443400	40	1 1/2"	M16	18	110	150	18
AN22520000	50	1"	M16	18	125	165	24
AN22540000	50	1 1/2"	M16	18	125	165	24
AN22620000	65	1"	M16	18	145	185	24
AN22640000	65	1 1/2"	M16	18	145	185	24

Code	Size	RC Internal Thread	Screw	D1	D2	D3	H	Description
AN22950000	125	2"	M16	18	210	250	31	Thread Flange(Aluminum)DN125-G2"
AN22960000	125	2 1/2"	M16	18	210	250	31	Thread Flange(Aluminum)DN125-G2-1/2"
AN22A20000	150	1"	M20	22	240	285	31	Thread Flange(Aluminum)DN150-G1"
AN22A40000	150	1 1/2"	M20	22	240	285	31	Thread Flange(Aluminum)DN150-G1-1/2"
AN22A50000	150	2"	M20	22	240	285	31	Thread Flange(Aluminum)DN150-G2"
AN22A60000	150	2 1/2"	M20	22	240	285	31	Thread Flange(Aluminum)DN150-G2-1/2"
AN22A70000	150	3"	M20	22	240	285	31	Thread Flange(Aluminum)DN150-G3"

Code	Size	RC Internal Thread	Screw	D1	D2	D3	H	Description
AN22820000	100	1"	M16	18	180	220	25	Thread Flange(Aluminum)DN100-G1"
AN22840000	100	1 1/2"	M16	18	180	220	25	Thread Flange(Aluminum)DN100-G1-1/2"
AN22850000	100	2"	M16	18	180	220	25	Thread Flange(Aluminum)DN100-G2"
AN22920000	125	1"	M16	18	210	250	31	Thread Flange(Aluminum)DN125-G1"
AN22940000	125	1 1/2"	M16	18	210	250	31	Thread Flange(Aluminum)DN125-G1-1/2"

Code	Size	RC Internal Thread	Screw	D1	D2	D3	H	Description
AN22720000	80	1"	M16	18	160	200	24	Thread Flange(Aluminum)DN80-G1"
AN22740000	80	1 1/2"	M16	18	160	200	24	Thread Flange(Aluminum)DN80-G1-1/2"
AN22750000	80	2"	M16	18	160	200	24	Thread Flange(Aluminum)DN80-G2"

Note : Standard configuration with flange seal , flange bolts



## Auxiliary Material Series



### Cantilevered Supports

Code	L	W	H	a	b	Description
AN24032300	300	60	140	41	41	Cantilevered Supports 30cm
AN24052300	500	60	140	41	41	Cantilevered Supports 50cm
AN24122300	1200	60	140	41	41	Cantilevered Supports 120cm

\* Standard configuration with 2 expansion screws, 1 sealing plastic cap



### Clamp Teet Cantilevered Supports

Code	L	W	H	a	b	Description
AN24032301	300	55	90	41	41	Clamp Teet Cantilevered Supports 30cm
AN24052301	500	55	90	41	41	Clamp Teet Cantilevered Supports 50cm

\* Two M10 screws have been equipped as standard, 1 sealing plastic cap



### Telescopic Supports

Code	L	L1	L2	a	b	Description
AN24242300	1200~2400	800	1700	80	120	Light-type Telescopic Supports 1.2m-2.4m (Used for Pipe Support Fixation)
AN24062300	1800~2000	1000	1750	120	200	Heavy-type Telescopic Supports (Used for DN63 Flange Valve Fixation)
AN24072300	1800~2000	1000	1750	120	200	Heavy-type Telescopic Supports (Used for DN80 Flange Valve Fixation)
AN24082300	1800~2000	1000	1750	120	200	Heavy-type Telescopic Supports (Used for DN100 Flange Valve Fixation)
AN24092300	1800~2000	1000	1750	120	200	Heavy-type Telescopic Supports (Used for DN125 Flange Valve Fixation)
AN240A2300	1800~2000	1000	1750	120	200	Heavy-type Telescopic Supports (Used for DN150 Flange Valve Fixation)
AN240B2300	1800~2000	1000	1750	120	200	Heavy-type Telescopic Supports (Used for DN200 Flange Valve Fixation)

\* Standard configuration with 4 expansion screws, 4 outer hexagonal screws in M5.5\*19mm

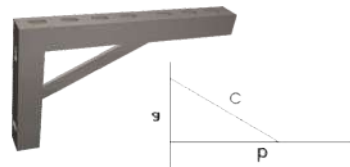

### Heavy-type Telescopic Supports

Code	a	b	c	Description
AN24112300	300	500	310	Triangular Heavy-type Telescopic Supports (Used For DN150 Pipe Above)

\* Standard configuration with 2 expansion screws



### L Type Connector

Code	D	L	c	Description
AN24142500	12.5mm	90mm	90mm	L Type Connector

\* Standard configuration with 4 outer hexagonal screws in M10\*25mm



### Clamp Teet

Code	D	L	c	Description
AN24122500	M8	36mm	25mm	Clamp Teet, Thred Direction Opening Opening 2.5cm



### C Type Steel

Code	L	a	b	Description
AN24332500	3m	41	41	C type Steel 41*41(3m)

## Auxiliary Material Series



### Press Plate

Code	D	a	b	Description
AN24132500	M10	70	45	Press Plate 70*45mm



### C Type Steel Base

Code	D	L	C	Description
AN24152500	13.5mm	150mm	102mm	C Type Steel Base, Supporring 41*41mm

\* Includes: self tap setscrew 2, M10\*6.5cm, fixing bolts 2

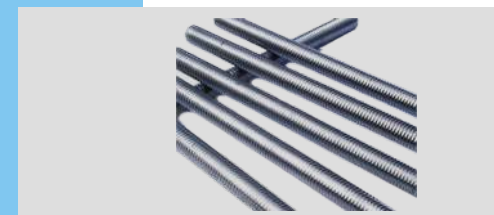

### Screw Rod / Connector

Code	D	L	Description
AN24222500	M8	40mm	Screw Rod Connector(Used For Lengthening Screw Rod)
AN24032500	M8	3000mm	Screw Rod, M8, 3m



### Inner Hexagonal Screw

Code	D	L	C	Description
AN24262500	M8	60mm	12	Inner Hexagonal Screw M8 , 6cm

\* Standard configuration with 1 gasket



### Expansion Screw

Code	D	L	Description
AN24274400	M10	50mm	Plastic Expansion Screw M10,6cm (Used For Wall Fixation)
AN24282500	M8	70mm	Internal Expansion Screw M8,8cm (Used For Wall and Floor Fixation)
AN24292500	M8	38mm	Combined Expansion Screw M8 (Used For Screw Ceiling Fixation)

\* Includes: self tap setscrew 2M5.5\*5cm



### Self-drilling Screw

Code	D	L	Description
AN24302500	M5.5	50mm	Hexagon Self-drilling Screw, M5.5*40mm
AN24312500	M5.5	19mm	External Hexagon Self-drilling Screw, M5.5*19mm

## Auxiliary Material Series



Flowmeter		
Code	Specifications	Description
AN27443400	40	VSF (Vortex Shedding Flowmeter),DN40
AN27553400	50	VSF (Vortex Shedding Flowmeter),DN50
AN27663400	65	VSF (Vortex Shedding Flowmeter),DN65
AN27773400	80	VSF (Vortex Shedding Flowmeter),DN80
AN27883400	100	VSF (Vortex Shedding Flowmeter),DN100
AN27993400	125	VSF (Vortex Shedding Flowmeter),DN125
AN27AA3400	150	VSF (Vortex Shedding Flowmeter),DN150
AN27BB3400	200	VSF (Vortex Shedding Flowmeter),DN200
The flow meter is not included: 485 communications and temperature compensation		
AN27010000	General	485 Communications
AN27020000	General	Temperature Compensation

\*Vortex flowmeter medium: compressed air, normal temperature and pressure, precision:1.0%, 24V power supply, 4-20MA output, liquid crystal display, instantaneous cumulative flow, material: stainless steel,flange to clamp connection,one piece



Auto Drain Valve		
Code	Specifications	Description
AN27091400	1/2"	Auto Drain Valve G1/2"
AN27101400	1/2"	Electronic Drain Valve , G1/2" (220V)



Gas Pressure Gauge		
Code	Specifications	Description
AN27101610	1/2"	Gas Pressure Gauge(Not Shockproof), 0-1.6MPa,1.6Level
AN27101600	1/2"	Gas Pressure Gauge(Shockproof), 0-1.6MPa,1.6Level
AN27121000	1/2"	Shock-absorbing Copper Tube,Internal Thread 1/2" - External Thread 1/2"



Terminal Filter		
Code	Specifications	Description
AN27010100	1/2"	Filter Regulator , 1/2"
AN27010200	3/4"	Filter Regulator , 3/4"
AN27010300	1"	Filter Regulator , 1"
AN27020100	1/2"	Combination Unit , 1/2"
AN27020200	3/4"	Combination Unit , 3/4"
AN27020300	1"	Combination Unit , 1"
AN27030100	1/2"	Triple Unit , 1/2"
AN27030200	3/4"	Triple Unit , 3/4"
AN27030300	1"	Triple Unit , 1"

## Terminal Connector



Hose		
Code	Specifications	Description
AN26011400	Φ8	软管100M(Pu)
AN26021400	Φ10	软管100M(Pu)
AN26031400	Φ12	软管100M(Pu)



Pneumatic Joint		
Code	Specifications	Description
AN26052800	1/2"	Single Pneumatic Joint, External Thread , R1/2"
AN26062800	1/4"	Two Pneumatic Joints, Internal Thread , R1/2"
AN26072800	1/4"	Three Pneumatic Joints, Internal Thread , R1/2"



Gas Gun		
Code	Specifications	Description
AN26041400	1/4"	Low Voice Gas Gun



Manifold	
Code	Description
AN26060200	Wall type manifold, G3/4" , G1/2" *2
AN26060300	Wall type manifold, G3/4" , G1/2" *3
AN26060400	Wall type manifold, G3/4" , G1/2" *4
AN26440300	Air distribution package , G1/2" outlets *3

\*The wall gas divider is reserved for internal thread holes, and corresponding number of quick-insert joints need to be configured separately, 2 sets of collision screws and 2 sets of drillingscrews are provided as standard for selection (except An26440300). Standard plastic expansion 2, 2 self tapping screws

# Tools Series

Large Demobox



Small Demobox



Demobox		
L	H	W
48	37	15
29	9	18



Manual Pipe Cutter	
Code	Description
AN25030100	Manual Pipe Cutter, 6mm-64mm
AN25030200	Manual Pipe Cutter, 48mm-116mm
AN25030300	Manual Pipe Cutter, 100mm-170mm
AN25040100	Manual Pipe Cutter Supporting Blade, 6mm-64mm
AN25040200	Manual Pipe Cutter Supporting Blade, 48mm-116mm
AN25040300	Manual Pipe Cutter Supporting Blade, 100mm-170mm

Deburring Tools	
Code	Description
AN25050100	Deburring Tools, Suitable For DN20-DN50



Hole Opener		
Code	Specifications	Description
AN25070100	14mm	Hole Opener, Suitable For 14mm Aperture, DN25
AN25070200	22mm	Hole Opener, Suitable For 22mm Aperture, Above DN40
AN25070300	43mm	Hole Opener, Suitable For 43mm Aperture, Above DN100

Drill Handle Opener		
Code	Specifications	Description
AN25060100	14-22mm	Drill Handle Opener
AN25060200	32-220mm	Drill Handle Opener

# Tools Series



Demobox			
Code	L	H	W
AN25010100	45	13	32



Electric Drill	
Code	Description
AN25090100	Electric Drill With One Battery And One Charger



Pipe Flange Maker	
Code	Description
AN25100100	Manual Pipe Flange Maker (Suitable For DN40-DN200 Aluminum Pipe)
AN25100200	Electric Pipe Flange Maker (Suitable For DN40-DN200 Aluminum Pipe)



Electrical Pipe Cutter	
Code	Description
AN25030400	Electrical Pipe Cutter, DN20-DN200
AN25040400	Electrical Pipe Cutter Supporting Blade, DN20mm-DN219mm



# 《Airtight Basic Guidelines For Product Installation》

## ● Safety and Health

1. All personnel entering the construction area should undergo safety training.
2. Enter the construction area must wear: safety helmet, protective shoes, work clothes, reflective clothes. You must wear a five - point seat belt and choose a reliable hanging point when climbing. Wear dust masks and earplugs when entering a dusty, noisy construction environment. Goggles should be worn in a splash - like environment such as cutting. Do not wear gloves when operating tools that rotate at high speeds.
3. When working at heights, workers should be configured with the above labor insurance supplies. It is advisable to choose a solid building or structure as a safety belt hanging point. When there is no ideal hanging point, ropes should be used to build hanging points. When working at heights, please manage the placement of tools, pipes and fittings to prevent falling from high places and hurt others. Tools and fittings are strictly prohibited from being transported vertically by means of throwing. The use of mobile scaffolding shall not exceed 3 layers, the scaffolding parts shall be fixed firmly, do not carry people while scaffolding moves.
4. When working near the edge, guardrail should be set up at the place near the edge first. If there is no condition to set up guardrail, a warning line should be set up at an appropriate position to prevent construction personnel from accidentally falling down.
5. Wear goggles to prevent splashing into the eyes during mechanical cutting and drilling operations. Fire extinguishers should be placed near metal cutting where sparks may occur. Pay attention to fire prevention.
6. Temporary power should be used in accordance with the site regulations, the principle of first application, then access, access to temporary power to ensure that the upstream switch has been turned off. When the electrical equipment is abnormal, the power should be disconnected for the first time, and should not be repaired when the power supply. When electrical appliances and circuits catch fire, disconnect the upstream power and use dry powder fire extinguisher to extinguish the fire, do not use water to extinguish the fire. Normal plug should be used for electrical equipment, and bare wire should not be used as plug.
7. The gas in the pipeline should be emptied during the pipeline maintenance. Construction with pressure is not allowed in any case.



## ● Pipes and Joints

1. Airtight piping must be used with Airtight fittings and can be used with Airtight threaded joints or flanges when connecting to traditional steel pipes and other types of piping.
2. Pipelines and valves should be effectively fixed to prevent in stability during system operation.
3. Airtight piping system should be protected from external impact.
4. Flexible connections shall be installed at the joints of equipment and settlement joints of buildings that generate vibration when the straight pipe length is relatively long.
5. Airtight pipeline system shall be used within its performance standards, shall not exceed the limits of use, shall not be used to transport toxic, harmful, combustible, combustion-supporting high-temperature medium.
6. The piping system should be installed horizontally and vertically, the pipe should not be twisted, and the joint should be evenly stressed.

## ● Some Suggestions

1. The piping system should not be reduced in diameter, and the choice of pipe diameter should fully consider the later expansion re-serve. When calculating pipe diameter selection, Airtight special calculation software can be used to fully consider the inverse relationship between pipe diameter and pressure loss to select the most suitable pipe diameter.
2. It is recommended to select different colors of Airtight pipes when piping with multiple medium and mark them on the pipe.
3. The installation location of the pipeline should be fully considered for retrofitting and overhaul. Pipes, valves, meters and other elevations should be fully considered for ease of operation, convenient maintenance, no blocking of passage and other factors.
4. For the first time to install the Airtight series products by yourself. It is suggested that we inform our company to send professional engineers for on-site installation training, and only those who pass the training and test can install the product.

## Bracket and Pipe Clamp Installation

### ● Fixed Way



## Bracket Spacing

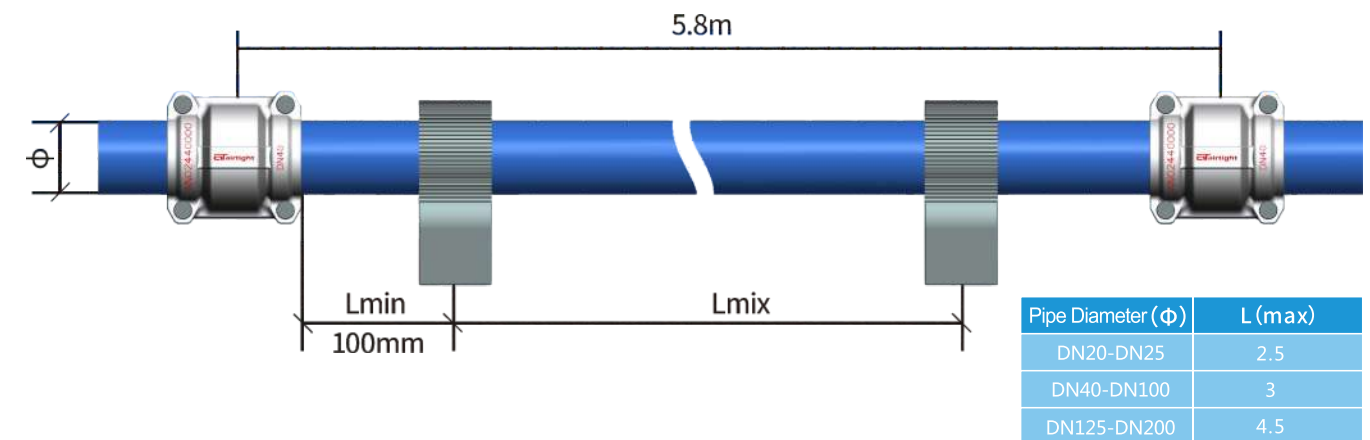

## ● DN20-DN25 Pipe Installation

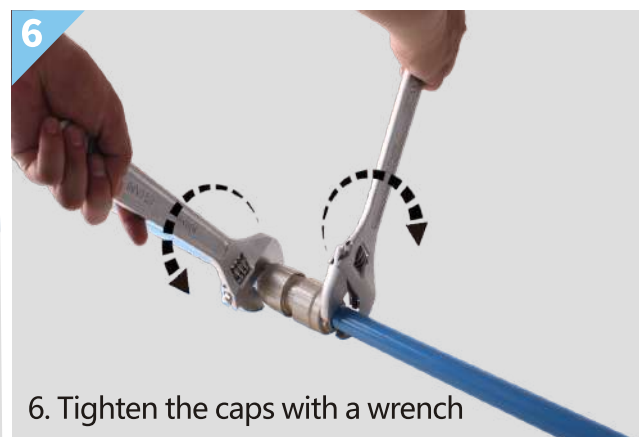
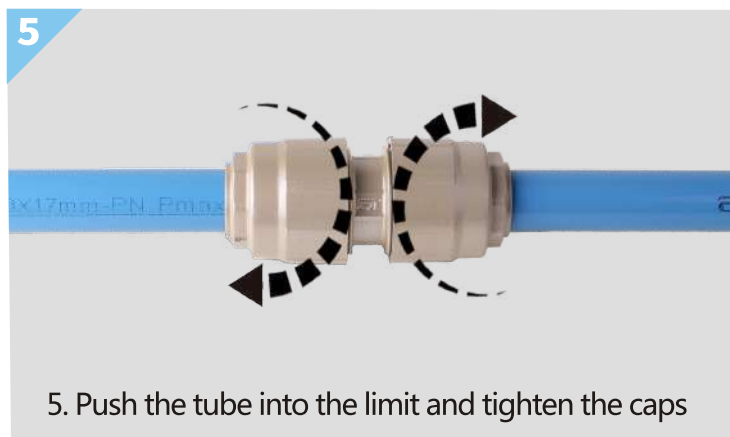
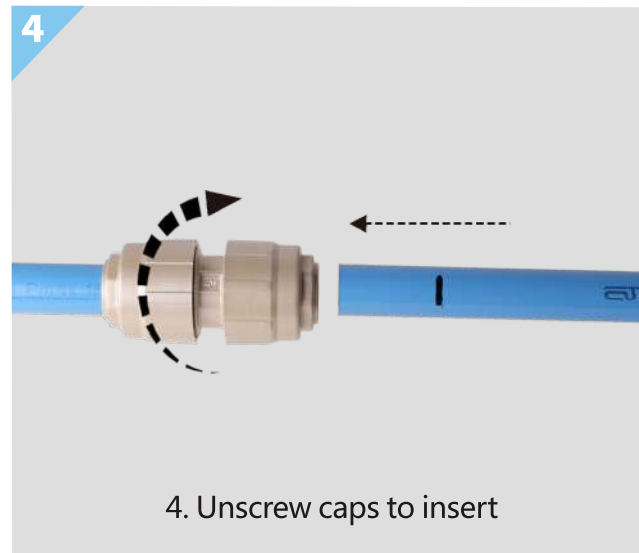
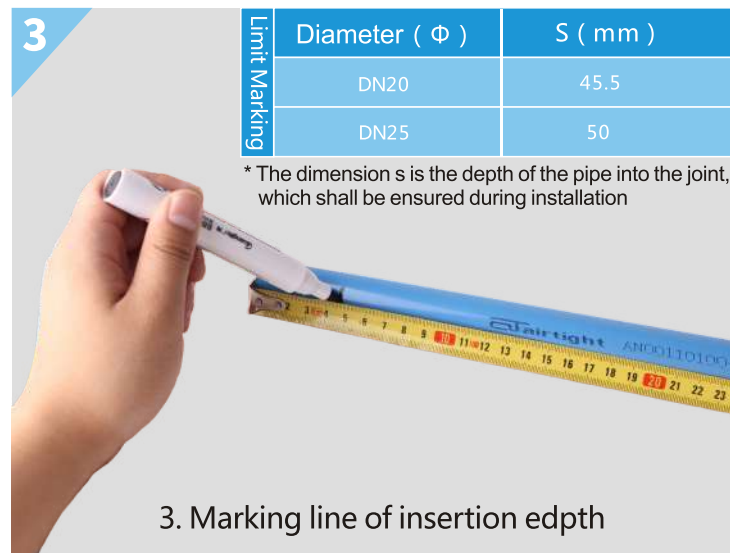
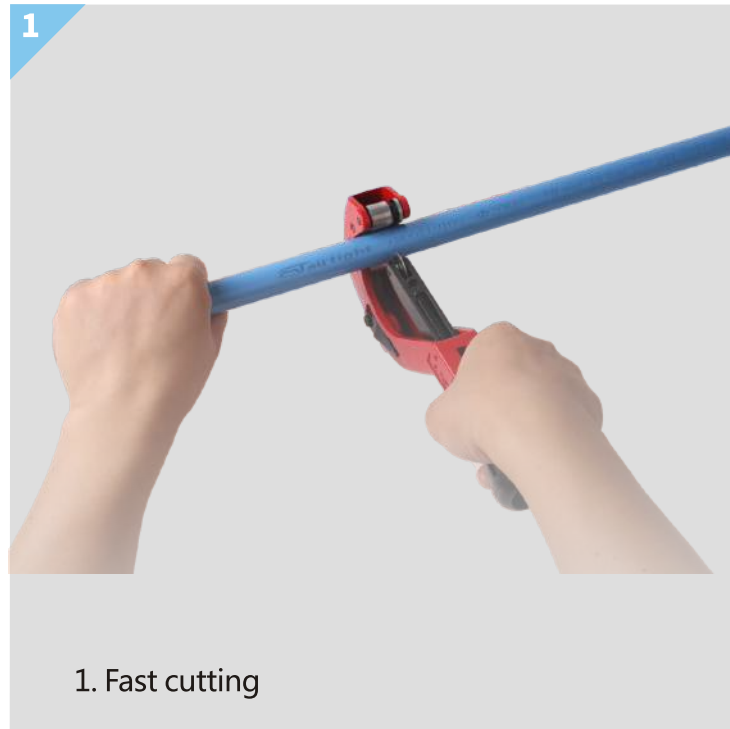

## ● DN40-DN50 Pipe Installation



Convex Tube Length	
Diameter ( $\Phi$ )	Insertion Depth S(mm)
DN40	30
DN50	30
DN63	45
DN80	45
DN100	45
DN125	45
DN149	45
DN200	45

\* The dimension s is the depth of the pipe inserted into the convex pipe, which shall be ensured when the pipe is convex



3. Pipe convex tube. The detailed description please refer 《Lugging Machine Operating Instructions》

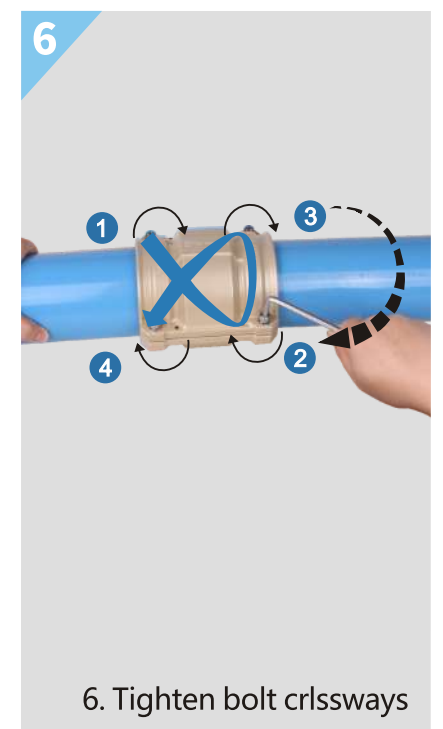
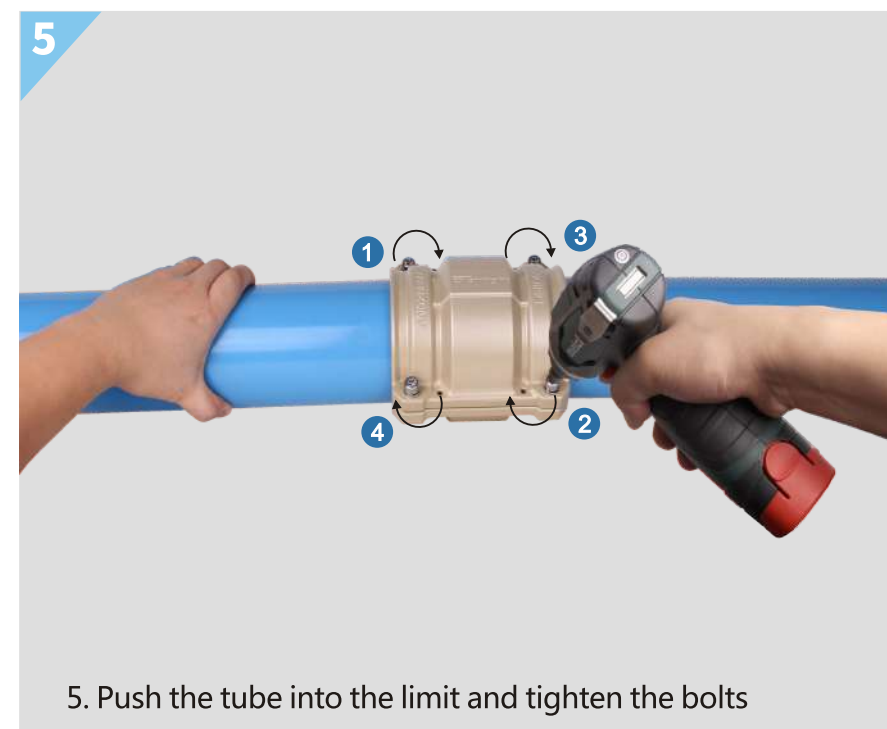
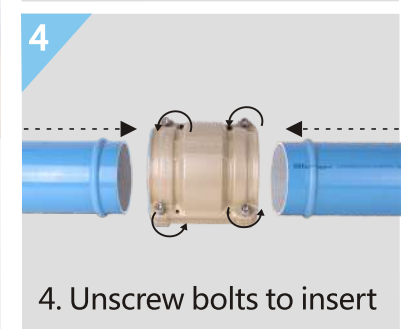



● Installation mode of quick change tee



● Hose installation

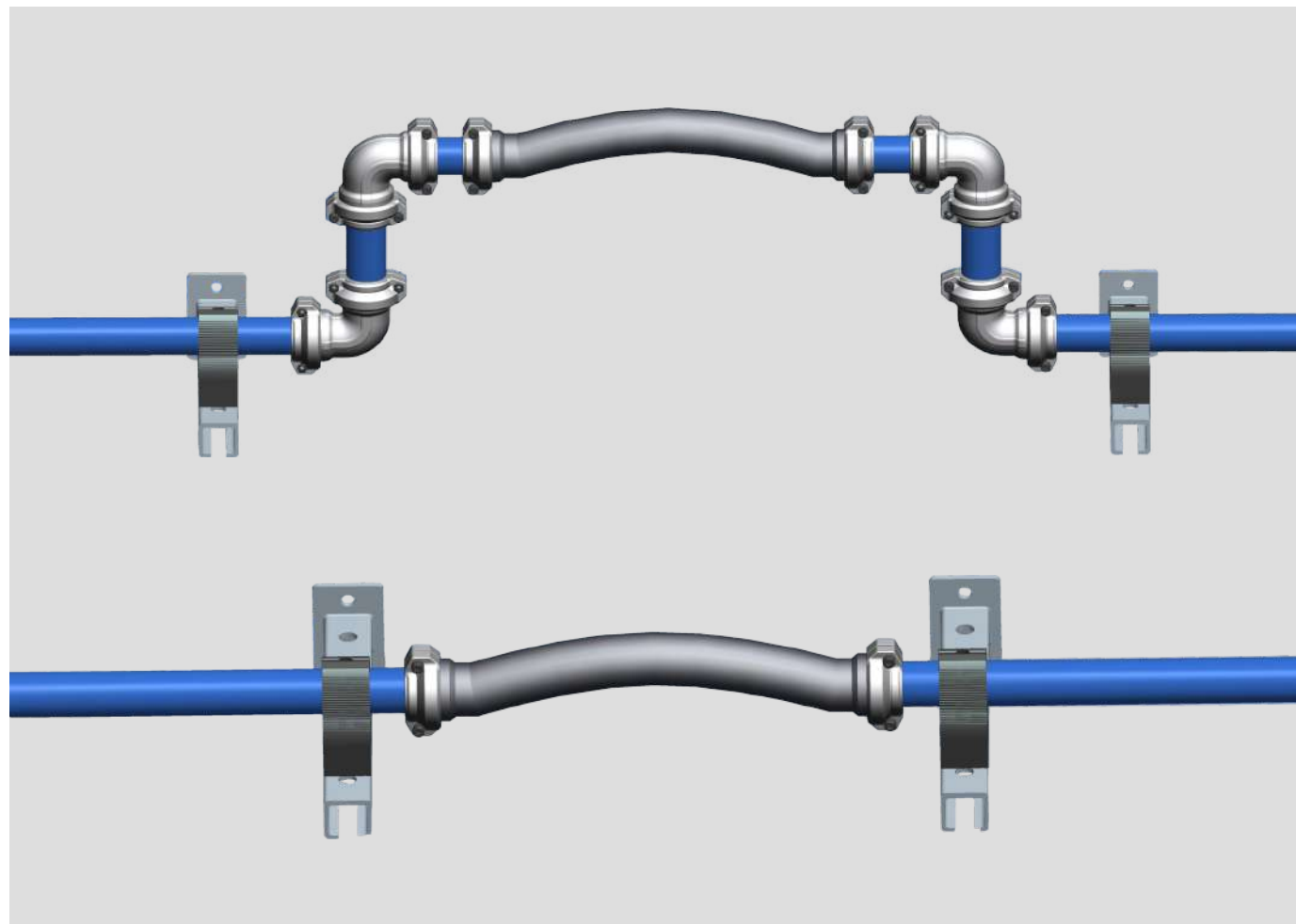

**Airtight Pressure test method and acceptance standard of compressed air pipeline**

● Reference basis

GB/T 51132- -2015《Code for construction and quality acceptance of industrial nonferrous metal pipeline engineering》  
 TSGD0001-2009 《 Supervision Regulation on Safety Technology for Pressure Pipelines - Industrial Pipelines》  
 《 Airtight Code for construction and acceptance of aluminum alloy pipes 》

● Objective

Ensure that the installed piping system meets production safety requirements, design requirements and operational standards.

● Pressure test method

(一) Preparation before pressure test

1. Prepare pressure test plan, take safety measures, and conduct safety and technical disclosure to operators.
2. If the pipe system is composed of two or more materials, the pressure test shall be carried out for pipes of different materials; The equipment, instruments, safety valves, etc. that do not or should not participate in the pressure test shall be isolated and closed.
3. For pressure test of aluminum alloy pipes, air pressure test can be used instead of hydraulic pressure, and safety measures should be taken. The medium should be dry and clean compressed air, nitrogen or other non flammable and non-toxic gases, and meet the national requirements for safety and environmental protection.
4. The pressure gauge used for the test shall be verified and within the validity period, the accuracy shall not be lower than 1.6, and the range of the pressure gauge shall be 1.5 to 2.0 times of the maximum measured pressure. There shall be at least two pressure gauges, and one pressure gauge shall be set at both ends of the test pressure pipe.
5. Check the insertion depth and tightening of all joints and fasteners of the pipeline system, and check whether plugs and valves are installed at the ends.
6. Use 0.2 MPa compressed air to conduct air supply pre test of pipe network, and then gradually open the valves at each air end for purging. After purging for 10 minutes, observe whether the pipe is clean and tidy at any purging port.
7. The test air pressure shall be boosted slowly. When the pressure rises to 50% of the test pressure, it shall be checked for pressure stabilization. In case of no abnormality or leakage, the pressure shall be increased gradually by 10% of the test pressure. The pressure shall be stabilized for 3min for each step of pressure increase; After the pressure rises to the test pressure, it shall be stabilized for 10min, and then the pressure shall be reduced to the design pressure. Check that there is no leakage at each interface and connection of the pipeline. When there is no pressure drop, the pneumatic test shall be judged as qualified.
8. In case of leakage during pressure test, repair under pressure is prohibited.
9. After passing the air pressure test, the pressure shall be reduced step by step to the atmospheric pressure outside the pipe according to 10% of the test pressure.

(二) Strength Test Data Sheet

Pipe type	Pipe working pressure p (MPa)	strength test			
		Test medium	Test pressure p (MPa)	time (min)	Qualification criteria
Compressed air pipe	P<0.5	Clean compressed air or inert gas is recommended	P<0.6	10	No leakage
	1.3 > P≥0.5		1.5 > P≥0.6		

(三) Tightness test data sheet

Pipe type	Pipe working pressure p (MPa)	strength test			
		Test medium	Test pressure p (MPa)	time (min)	Qualification criteria
Compressed air pipe	P<0.5	Clean compressed air or inert gas is recommended	P	30	No leakage no pressure drop
	P≥0.5				



## Pipe diameter selection

1. According to the required flow and pressure drop values, you can choose the most suitable Airtight pipe diameter for your piping system
2. The pressure set in the following table is 8bar, and the pressure drop is 5%.

Example : Ring pipe with a length of 500 meters in the main pipe network system  
 The demand flow is 2000 m<sup>3</sup> / h  
 Working pressure is 8bar  
 The most appropriate Airtight pipe diameter is DN100

You can contact our technicians to select the appropriate pipe diameter and corresponding optimization service for your pipeline system.

Flow m <sup>3</sup> /min	length (L)				
	L≤200m	200m<L≤500m	500m<L≤1000m	1000<L≤1500m	1500m<L≤2000m
0.16	20	20	20	20	20
0.5	20	20	25	25	40
0.8	20	25	40	40	40
1.2	25	25	40	40	40
1.5	25	40	40	40	40
3	25	40	40	50	50
4	40	40	50	50	50
6	40	50	50	63	63
9	40	50	63	63	63
13	40	50	63	80	80
18	50	63	80	100	100
20	50	63	100	100	100
25	63	80	100	100	100
30	63	80	100	100	100
35	63	80	100	100	125
42	63	80	100	125	150
50	80	100	125	150	150
60	80	100	125	150	150
68	80	100	150	150	150
75	80	125	150	150	150
84	80	150	150	150	150
92	100	150	150	150	150
100	100	150	150	150	150
110	125	150	150	150	150
115	125	150	150	150	200
125	150	150	150	200	200
130	150	200	200	200	200
140	150	200	200	200	200
160	200	200	200	200	200
180	200	200	200	200	200
200	200	200	200	200	200

## Pipe diameter calculation

### Flow Calculator

According to:

- Flow( Nm<sup>3</sup>/hr,NI/min,Scfm)
- working pressure ( bar, kpa, psi)
- Pipe diameter length ( m, feet, yards)
- pipe diameter ( mm)

Good to know!  
 We recommend the use of a ring main line.  
 A ring main line has only half of the pressure drop than that of a straight run for the same overall length of pipe.



# Enterprise qualification



Business license



Certificate of High tech Enterprise



Type test certificate of special equipment



CE certificate



ISO 9001 certification



ISO 14001 certification

## Inspection report



Inspection report DN20-DN50



Inspection report DN125-DN200



Salt spray test report



Salt spray test report

## Patent certificate



## cooperative partner

Serving more than 18000 customers

Automobile Industry	New Energy Industry	Electrical Industry	Electronics Industry	Auto Parts Industry	Home Industry	Medical Industry	Tobacco Alcohol Food Industry
Mercedes-Benz	CATL 宁德时代	SIEMENS	FOXCONN 富士康	ADIANT 安道拓	OLO 我乐 整体厨柜   全屋定制	yuwell 鱼跃	五粮液
CHERY	BYD	BOSCH	LUXSHARE ICT	中国中车 CRRC	ZBOM 志邦厨柜	UNITED IMAGING 联影	中粮 COFCO
Das Auto.	南都电源 Narada	Midea美的	MIFLEX A DFB Company	TUO PU 拓普	科勒 KOHLER	天衍医疗 ITI MEDICAL An AK MEDICAL Company	江中
蔚来 NIO	阳光电源 SUNGROW	Panasonic 松下电器	Pro-face 普洛菲斯	brose 博世汽车技术	SAYAS 森鹰铝木窗	云南白药	思念
长安汽车 CHANGAN	SVOLT 蜂巢能源	Schneider Electric 施耐德电气	台达 DELTA	W.W. automotive	金牌厨柜	邦士医疗 BONSS MEDICAL	中国烟草 CHINA TOBACCO
吉利汽车 GEELY AUTO	赣锋锂业 Ganfeng Lithium	博西华 BSH	协和电子	均胜电子 JOYSON ELECTRONICS	Treezo 千年舟集团 TREEZO GROUP	私语红牛集团	红牛集团
Ford	ARASIS 孚能科技	BULL公牛	SCC 深南电路	米其林轮胎 MICHELIN	王力 WONLY	HESHOU	云烟